

Mike
Dobson



19 Abbeystone Way
Monk Fryston, Leeds, LS25 5NF

Chain Free £150,000

19 Abbeystone Way

We are pleased to present to the market this two bedroom first floor apartment situated within a cul-de-sac in a pleasant development in Monk Fryston, having easy access to local amenities. The accommodation briefly comprises: communal entrance with staircase to first floor, entrance hall, open plan lounge/kitchen/diner, two double bedrooms with en-suite to the main room and bathroom/WC. In addition, the property has double glazing throughout, gas central heating with combination boiler, fitted kitchen with integrated appliances, three piece white suites to the en-suite and bathroom/WC. Outside, there are communal lawned gardens and an allocated parking space to the front. An early viewing is highly recommended.

Council Tax Band C





Floor Plan

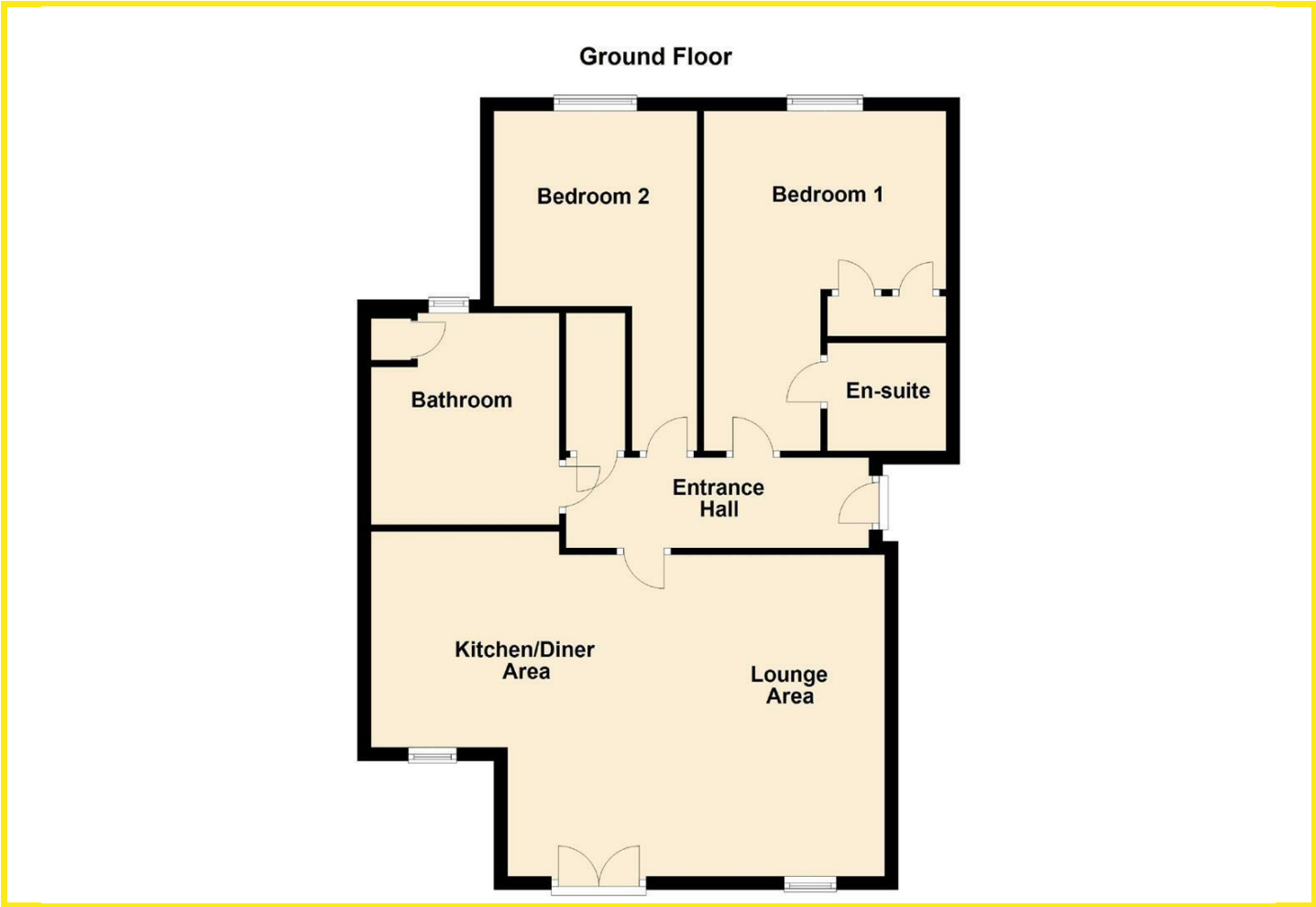

Area Map



Energy Efficiency Graph

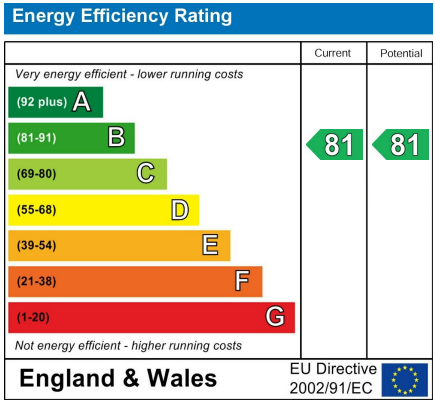

Directions

From our Sherburn In Elmet office turn left onto Low Street and follow this road to South Milford. Continue through the village of South Milford to the roundabout. Take the second exit onto Lumbly Lane and towards Monk Fryston. The turning for Abbeystone Way is just over the railway bridge on the right hand side.

These particulars, whilst believed to be accurate are set out as a general outline only for guidance and do not constitute any part of an offer or contract. Intending purchasers should not rely on them as statements of representation of fact, but must satisfy themselves by inspection or otherwise as to their accuracy. No person in this firms employment has the authority to make or give any representation or warranty in respect of the property.